

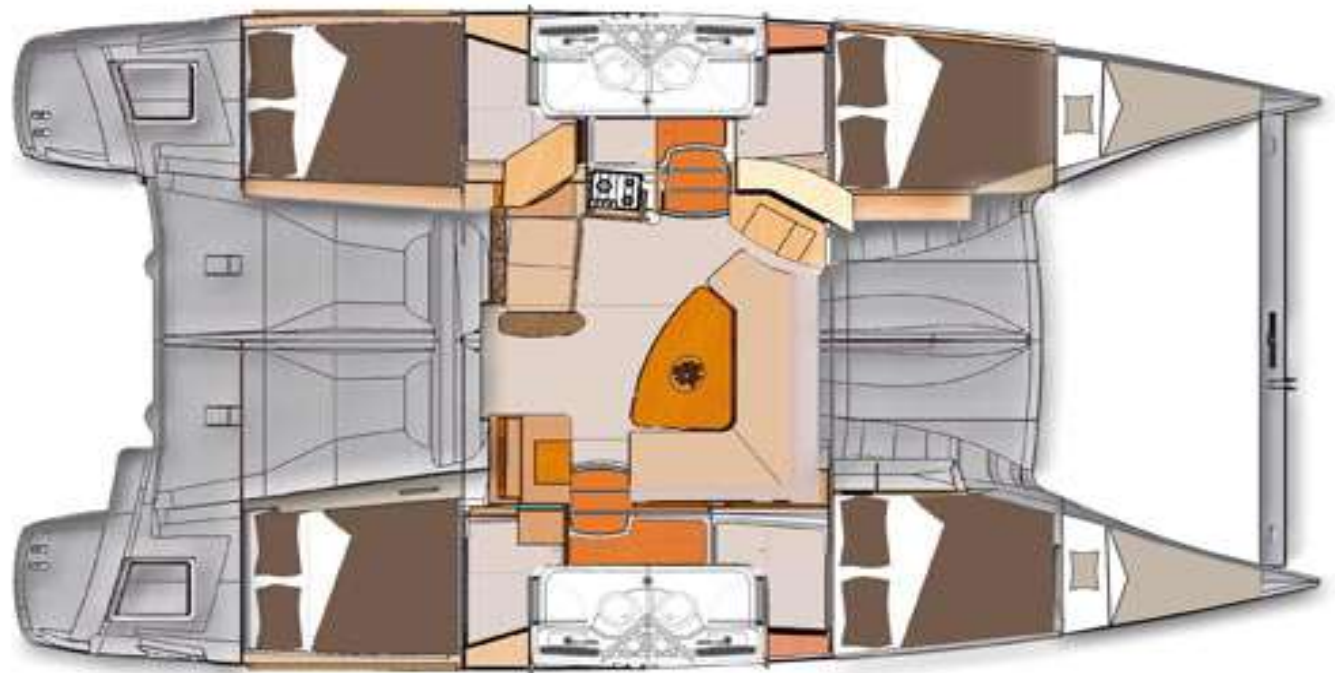

Sailing Catamaran - Fountaine Pajot Lipari 41 *quatuor* - Mirada

Presentation

Boat Name	Mirada
Type	Sailing Catamaran
Shipyards	Fountaine Pajot
Model	Lipari 41 Quatuor
Sails	Square top mainsail with lazybag
Built in	2013
Flag	Turkey
Port of Registry	Marmaris
Overall length	11,95 m
Beam	6,73 m
Draft	1,15 m
Displacement	7,60 t
Engine Model	Volvo Diesel
Engine Power	2 * 30 HP
Fuel Capacity	300 Lt





Sailing Catamaran - Fountaine Pajot Lipari 41 *quatuor* - Mirada

Technical specifications

Cabin Layout

Double Cabins	4
Crew cabins	2
Salon berths	2
Total berths / license	12 / 10

Hydraulic Systems

Toilets	4
e-Toilets	aft WC's ✓
Black water capacity	4 * 50 Lt
Fresh water capacity	530 Lt

Climate Control & Electrical System

220V Shore power with charger	Inverter 300W
Solar Panels	Fan in cabins and salon
USB Sockets in cabins & salon	220 Lt fridge

Galley

Complete Kitchen Equipment for 10 pax

Entertainment Systems

Bluetooth AUX Player with loudspeakers in salon & cockpit

Hull & Deck

Hardtop Bimini on Cockpit and Sunbrella Bimini with Sprayhood on Helm
 Cockpit table & cockpit cushions 2 Gas bottles and adaptor
 Dinghy with oars

Engine

Volvo Diesel 2 * 30 HP

Rigging & Sails

Square top mainsail & lazybag, Furling genoa, Total sails area 89,5m²
 Electrical maneuver winch Optional Gennaker

Navigation

Garmin 5012 Chartplotter at helm station
 1 Steering Wheel with 2 Rudders Radar reflector
 Garmin Autopilot Windex
 Garmin VHF Phone Binoculars
 Depth & Temperature repeaters Search light
 Wind & speed direction Compass
 Ruler & divider Sea charts

Mooring & Anchoring

Electrical Windlass with remote & chain counter on flybridge
 20Kg Anchor with 100m chain & spare Anchor 20Kg with rope
 4*15m, 30m, 50m mooring lines, 10 sausage & 4 balon fender

Safety equipment

Complete Safety Equipment for 10 pax